

Handheld Pulse Oximeter

Model: SA310



Optional Accessory:



Adult Probe
PA100



Neonatal Probe
PB100



Pediatric Probe
PC100



Disposable Probe
PD100



Tube Probe
PF100

Pulse Oximeter

- Ideal for oxygen therapy assessment
- Ideal for sleep apnea screening
- Ideal for health management
- Ideal for spot-check & continuous monitoring

- Big 2.4" color TFT display
- Personal SpO₂, Pulse Rate, Memory Interval thresholds setting
- Shielded Design blocks Ambient Light
- Biocompatibility & Anti-Allergic Design
- Alert function
Device delivers audible warning when measurement result exceeds the SpO₂/Pulse Rate thresholds previously set.
- Silent mode
Disables the beep sound during the measurement by pressing the "Sound" button.
- Up to 999 Memories
Could be programmed with 3 intervals: 10 / 30 / 60 seconds
- Bluetooth® Transmission
- Pulse Strength Indicator
- Dual power source
- Protection pouch



%SpO₂ &
Pulse Rate



2.4" Color
Display



High/Low SpO₂,
PR & Memory Interval
Setting



Shielded Design
blocks Ambient Light

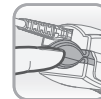

Biocompatibility &
Anti-Allergic Design



Alert &
Sound Off



Up to
999 memories



Pulse Strength
Indication



Battery and
AC Adaptor



Protection Pouch



Bluetooth®
Transmission

The Bluetooth® word mark and logos are registered trademarks owned by the Bluetooth SIG, Inc. and any use of such marks by Rossmax International Ltd. is under license. Other trademarks and trade names are those of their respective owners.

Specification

Measurement Range | SpO₂: 35%~100%; PR: 30~250 bpm

Precision | SpO₂: 70%~100%; ±2%; 35%~69% (unspecified); Pulse rate: 30~250bpm; ±3

SpO₂ Accessory | Adult Probe Included, Pediatric / Neonatal Probe Optional

Power Supply | 4 x "AA" Alkaline / AC Adaptor

Model	Qty per carton	Carton volume
SA310	10 pcs	0.055 cbm/ctn

- Storage temperature: -25°C - 70°C (-13°F - 158°F)
- Relative humidity: 15% - 90% (no condensing)
- Atmospheric Pressure: 700 to 1060 hPa

Distributed by:

CONSTAR X PTY LTD

Unit 4, 68 Parramatta Road, Underwood, QLD 4119,
Australia. Ph: 1300 778 924

www.constar.com.au